



Hudson 1500 Vanity

SKU#: J-2045

\$423.00

HANDLE OPTION



BENCHTOP OPTION

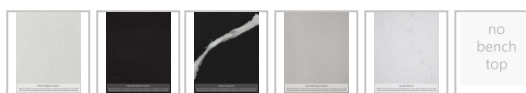

TAP CUTS



BASIN OPTION



Standard Basin Size: 460mm x 340mm x 150mm*

Standard Stone Size: 1500mm x 480mm x 20mm*

Cabinet Size: 1480mm x 465mm x 415mm

Cabinet Finish: White High Gloss

Stone Top Standard 20mm: White Pepper, Midnight Black, Black Calacatta, Concrete Grey, Venato Bianco

Basin: Ceramic Undermounted with Overflow

Handle: Brushed Chrome Square

Configuration: Four Soft Closing Doors and Two Soft Closing Drawers

Warranty: 2 Year Product Warranty

****Selecting different options may change these dimensions, please refer to the specification images.***

The Hudson vanity is both beautiful and practical, the ceramic basin is under mounted, which neatly tucks under the stone counter top. The compact double sink still allows for ample bench space for all things bathroom. Featuring sleek square chrome satin handles, soft closing doors and drawers. See store for matching 1200mm Tap and waste fittings shown in the photos are for illustration purposes only and are sold separately, add them to your order to complete your look.

Please note that stone and timber samples may differ from the actual product due to natural variations and batch differences. Colours displayed online may appear different due to screen settings. Standard stone and timber benchtops are supplied without holes, allowing for installation flexibility unless you choose to add tap hole options to your order when selecting your benchtop. For ceramic products,*

specifications must allow +/- 10 mm tolerance for manufacturing variance, it is recommended to use measurements of the actual product received.

****This hole cutting service is exclusively available with Fontaine's benchtop products only. If your benchtop is in stock, the lead time for this service is 5 business days, please add an additional 5 business days to the estimated arrival date (ETA) for out of stock products. We will provide general recommendations for standard tap hole positions to ensure compatibility with your vanity. Custom positions can be accommodated; however, please be aware that the buyer will be responsible for any discrepancies, as Fontaine cannot be held liable for issues arising from custom placements. A template will be provided for your approval before we proceed with the hole cutting process. Once approved, the cutting positions will be final. This service is classified as a special order, Fontaine cannot accept returns or refunds for any benchtop services or products once the templates have been approved and signed off.**

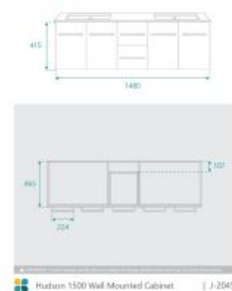

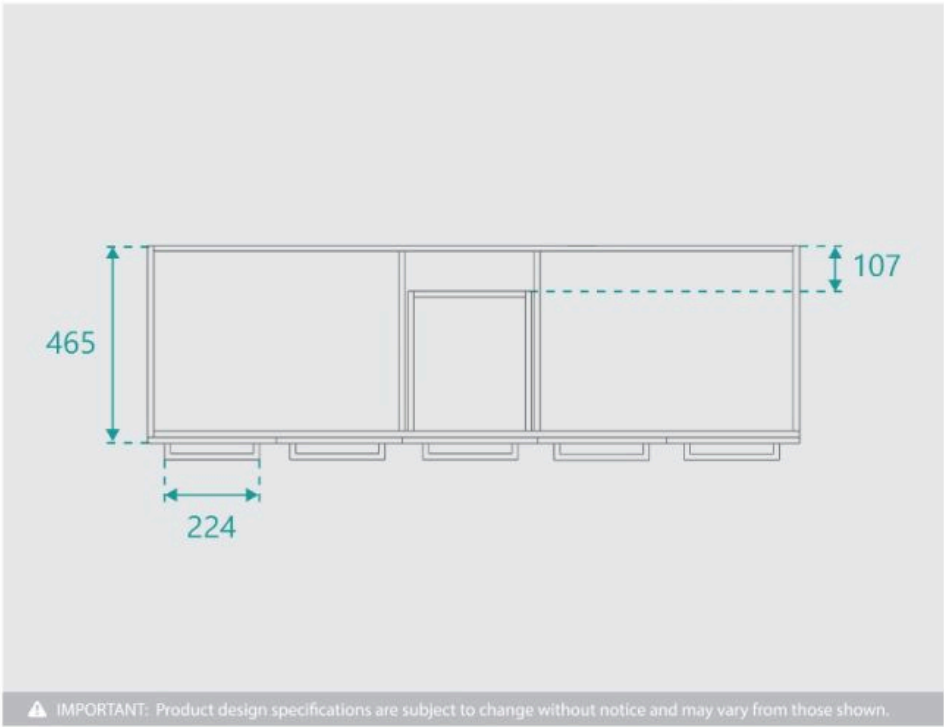
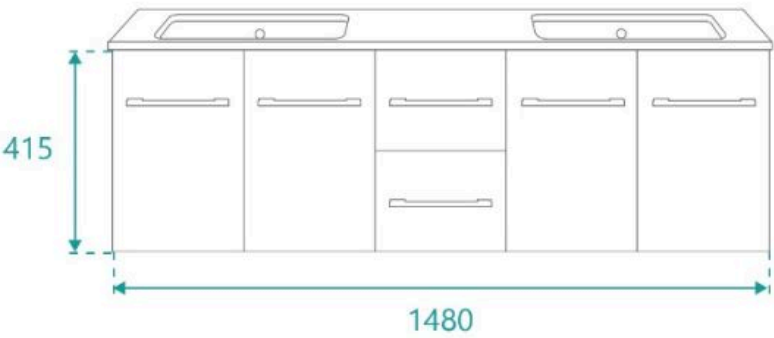

Hudson 1500 Wall Mounted Cabinet

| J-2045